

*Master
Planning &*
Landscaping

Designing spaces that inspire community



Moon Park

Madinat Riyadh City

A Striking Landmark Blending Art and Architecture

The development of Moon Park within the Madinat Riyadh District represents a visionary opportunity to establish a distinctive public space that celebrates the area's unique natural and cultural identity. Conceived as more than just a park, it is designed to be a local landmark and community destination, seamlessly blending science, art, and sustainability.



Moon Pavilion

The Moon Pavilion stands as the defining centerpiece of the park, where architecture and artistry blend into one. Its sweeping lattice dome creates a sculptural landmark that is both iconic and functional — offering shade by day and a striking silhouette by night. More than a structure, it is an open invitation for people to gather, pause, and share moments of connection within a space that celebrates innovation and cultural expression.

Complementing this is the Moon Gate, a poetic passageway that frames the landscape with elegance. Draped in cascading flora and illuminated with soft lighting, it transforms a simple entry into an enchanting threshold, symbolizing the transition from the city's bustle into a world of leisure, nature, and imagination. It is not merely an architectural detail but an experience that welcomes every visitor with a sense of wonder. Adding to the park's vibrant rhythm is the Moonlit Café — a contemporary pavilion designed as a social anchor. With its flowing circular canopy and open-air seating, it offers a relaxed setting



Moon Gate



Moonlit Café

where families, friends, and individuals can gather. It blurs the line between indoors and outdoors, encouraging conversation, reflection, and community life against the backdrop of landscaped greenery.

Together, these architectural gestures elevate Moon Park beyond a recreational space into a living cultural landmark. They weave art, nature, and daily life into a seamless narrative, establishing the park as a vibrant stage for human interaction — a place where harmony between design and community is not just envisioned but brought to life. These elements together create a harmonious environment that inspires creativity, relaxation, and a deeper connection with nature.



Concept Design



Moon Crater Play



Running Track



Fitness Station Changing

Concept Design

Moon Park's concept design envisions a holistic landscape anchored by a central green lawn that links play, fitness, leisure, and cultural zones through fluid pathways. The amphitheater acts as the cultural heart for performances, while flexible lawns adapt to both daily relaxation and community events. Active energy comes from basketball, padel, and multi-use courts, balanced by shaded paths and viewing spots that bring moments of calm.

Children take center stage with the Moon Crater Play Zone and toddler areas offering layered, imaginative experiences. The celestial theme extends through features like the Constellations Path and Bounce Park, reinforcing the park's identity with creativity and wonder. Comfort is enhanced by shaded seating, rest areas, and changing facilities, all integrated seamlessly into the design.

The result is a dynamic yet balanced landscape where movement flows effortlessly, offering something for everyone. Whether for recreation, fitness, cultural activity, or quiet retreat, Moon Park emerges as a sustainable microcosm of urban life — vibrant, engaging, and rooted in a sense of community.

The design also emphasizes sustainability by incorporating eco-friendly materials, efficient irrigation systems, and native plant species that thrive in the local climate.

More Than a Park— A Destination of Togetherness

The park's design prioritizes sustainability and function as much as aesthetics. Native planting enhances beauty while conserving water and supporting biodiversity, and shaded canopies with energy-efficient lighting ensure comfort and year-round usability for the community.

Moon Park offers layered experiences for every visitor. The Rebound Wall, Padel, and Muga courts engage sports enthusiasts, while the Water Play Zone and Dry Deck Fountain bring refreshing fun for families. Cultural life thrives in the Amphitheatre and Picnic Zones, where casual gatherings become moments of celebration. Completing the journey, the Observation Deck provides sweeping city views that invite reflection and pause.

Every detail — from seating and lighting to circulation and irrigation — has been executed with precision, merging environmental sensitivity with human-centered design. This careful balance transforms Moon Park into more than just a green space; it becomes a living canvas of community life, where architecture, art, and nature converge seamlessly.

Ultimately, Moon Park is more than a destination; it is an experience that nurtures well-being and community.



Rebound Wall



Padel Court



Muga Court



Water Play



Picnic Zone



Dry Deck Fountain



Flexible Zone



Amphitheatre



Observation Deck



Baniyas Sunset Park

Abu Dhabi

Art, Architecture, and the Desert in Harmony

Envisioned as a cultural and recreational landmark, Baniyas Sunset Park transforms the desert landscape into a vibrant public destination. The design integrates native planting, shaded promenades, and contemporary architecture, offering a sustainable response to the region's climate.



Sunset from the Ring



Stage Area

The elevated ring walkway offers a unique perspective across the park and surrounding landscape. At sunset, it transforms into a striking destination where visitors can enjoy sweeping views and experience the seamless connection between art, architecture, and nature.

Meandering through shaded groves, the bike and walking tracks invite exploration and movement while maintaining harmony with the desert setting. Designed for leisure and wellbeing, they create opportunities for both active recreation and quiet immersion in nature. The open-air stage provides a dynamic space for performances, cultural programs, and community gatherings. Surrounded by landscaped seating and shaded lawns, it establishes the park as



Bike & Forest Tracks



Majlis

a hub of creativity and shared experience. Blending tradition with contemporary design, the Majlis offers a welcoming place for rest and social connection. Set within a landscape of native planting, it reflects the essence of hospitality while providing shaded comfort in the heart of the park.

The park's layout emphasizes accessibility and flow, ensuring that visitors can easily move between activity zones without congestion. Shaded walkways, open green areas, and strategically placed seating encourage both relaxation and social interaction, while sustainable landscaping enhances comfort throughout the year.

A Timeless Destination of Connection

Play Zone

The Play Zone is designed to spark imagination and joy for children of all ages, with dedicated toddler areas, adventure play structures, and splash pads that encourage safe, active, and social play. These engaging spaces blend seamlessly into the landscape, offering shaded comfort and opportunities for families to connect.

Sports & Fitness

Sports and Fitness facilities bring energy and movement to the park, with multi-use courts, climbing walls, and a skate park that cater to a wide range of activities and skill levels. By integrating vibrant, contemporary sports spaces into a natural desert setting, the design promotes wellbeing, inclusivity, and an active lifestyle for the entire community.

Socializing, Gathering & Facilities

Social spaces and facilities establish the park as a true community hub. From bustling marketplaces and cafés to welcoming petting experiences, every element is designed to foster connection, hospitality, and cultural exchange. Together, they create a setting that is not only recreational, but also enriching — a place where people gather, share, and celebrate life.



Kid's and Toddler's Play areas



Adventure Play



Splash Pad



Sports Court



Climbing Wall



Skate Park



Market Place



Restaurant & Cafe



Petting experience



Baniyas Heritage Pak

Abu Dhabi

A Living Tapestry of Culture and Landscape

Baniyas Heritage Park is envisioned as a vibrant and sustainable landmark that celebrates Emirati culture while embracing modern design. Rooted in tradition yet forward-looking, it blends native landscapes, eco-conscious infrastructure, and inclusive spaces.



Stage & Lawn



Sport & Recreation

Baniyas Heritage Park has been conceived as a cultural and recreational landmark that brings people together in a setting where heritage and modern design coexist seamlessly. At its heart, the park creates spaces for gathering, celebrating, and connecting, while offering visitors a green escape rooted in Abu Dhabi's identity.

The stage and lawn serve as a vibrant hub for performances, festivals, and community events. Designed as a flexible open-air venue, it provides a dynamic space where culture and leisure converge, offering memorable experiences for residents and visitors alike. Active living is celebrated through dedicated sports and recreation facilities, including multi-purpose courts and shaded



Heritage Promenade



F&B Food Trucks

play zones. These areas are thoughtfully integrated with walkways and landscapes, encouraging health, wellness, and engagement for all age groups.

Adding vibrancy and social energy, the heritage promenade and F&B zone provide immersive experiences that celebrate tradition and community. From shaded promenades and cultural detailing to lively food truck plazas, these amenities create welcoming spaces where families can relax, dine, and connect, enriching the park's role as a true destination of togetherness.

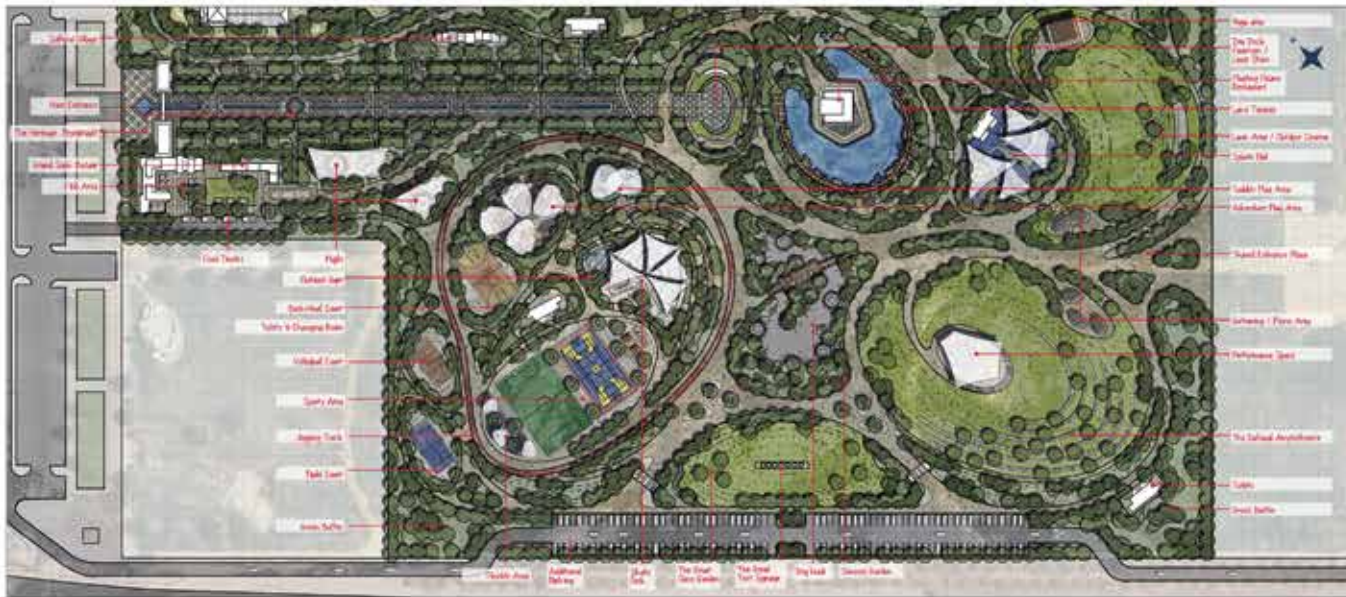

Concept Design

Concept Design

The concept design for Baniyas Heritage Park is guided by a thoughtful master plan that weaves together cultural identity, sustainability, and community needs. The layout organizes key zones into a fluid and interconnected network, balancing active recreation with serene green spaces.

Among the unique amenities, the Forest Classroom creates an engaging outdoor learning environment, encouraging exploration and environmental awareness. This space connects children and families to nature through interactive experiences that foster curiosity, education, and cultural storytelling within a shaded and natural setting.



Forest Classroom



Luxuri Glamping Tents



Hardscape Palette



Lighting



Furniture



Playground & Fitness

For those seeking leisure with comfort, luxury glamping tents provide a refined retreat within the park, blending modern amenities with an authentic natural backdrop. These facilities expand the park's offering beyond daytime recreation, inviting visitors to enjoy overnight stays that immerse them in both cultural heritage and contemporary outdoor living.

Hardscape and softscape palettes are carefully selected to reflect the region's identity while ensuring comfort, sustainability, and visual coherence. Together, these elements create a layered environment where culture, learning, wellness, and leisure converge in a single, unified landscape.

A Living Canvas of Culture and Community

Play Zone

The Play Zone offers spaces designed to inspire joy, activity, and exploration for all ages. From the adventure play areas and splash pads to the iconic Falcon's View Zipline, these features create excitement and memorable moments, encouraging families and children to engage with the landscape in dynamic and playful ways.

Sports Zone

The Sports Zone reflects the park's commitment to wellness and active living. With casual sports courts, running and walking tracks, and dedicated recreation areas, it seamlessly integrates health-focused amenities into a shaded, accessible, and inclusive environment that encourages year-round activity.

Socializing, Gathering & Support Facilities

Complementing these active spaces, the park embraces social and cultural connections through unique gathering points. Highlights include the Floating Palace Restaurant, traditional-style majlis for community interaction, and the vibrant Grand Soul Bazaar — all fostering a sense of belonging while celebrating local heritage. Together, these amenities embody the park's vision of blending culture, leisure, and sustainability.



Adventure Play



Falcon's View Zipline



Splash Pad



Casual Sports Zone



Sports Court



Running & Walking Track



Floating Palace Restaurant



Majilis



Grand Soul Bazaar



Baniyas Droplet Park

Abu Dhabi

Shaping Spaces with the Beauty of Water

Baniyas Droplet Park is envisioned as a landmark public space where the elegance of water droplets inspires fluid circular designs, weaving together lakes, play zones, sports courts, cycling tracks, and cultural hubs into a sustainable and vibrant community destination.



Fountain Plaza

At the heart of Baniyas Droplet Park, the Fountain Plaza serves as a central gathering space where water, landscape, and community life converge. Designed with circular forms inspired by water droplets, it blends shaded seating, vibrant fountains, and open views across the lake. This plaza is more than a visual landmark — it is an inclusive space for relaxation, interaction, and cultural gatherings, embodying the park's vision of harmony and flow.

The Lake & Zipline add an adventurous spirit to the park, combining natural beauty with dynamic recreation. Visitors can enjoy the serene ambiance of the water while engaging in thrilling zipline rides that glide across the lake, offering panoramic views of the park's lush greenery and circular landscape design. This feature symbolizes the balance of calm and excitement, encouraging both leisure and activity within a sustainable, thoughtfully designed environment.



Lake & Zipline



Toddler Play Area

Catering to younger visitors, the Toddler Play Area creates a safe and engaging space where children can explore, play, and learn. Designed with shaded structures, imaginative play equipment, and soft landscaping, it provides families with a dedicated zone that encourages physical activity, creativity, and social interaction.

Together, these elements illustrate the park's holistic vision — blending art, recreation, and sustainability into a cohesive public space. Here visitors experience a destination that celebrates movement, connection, and community while reflecting Abu Dhabi's cultural and natural identity.

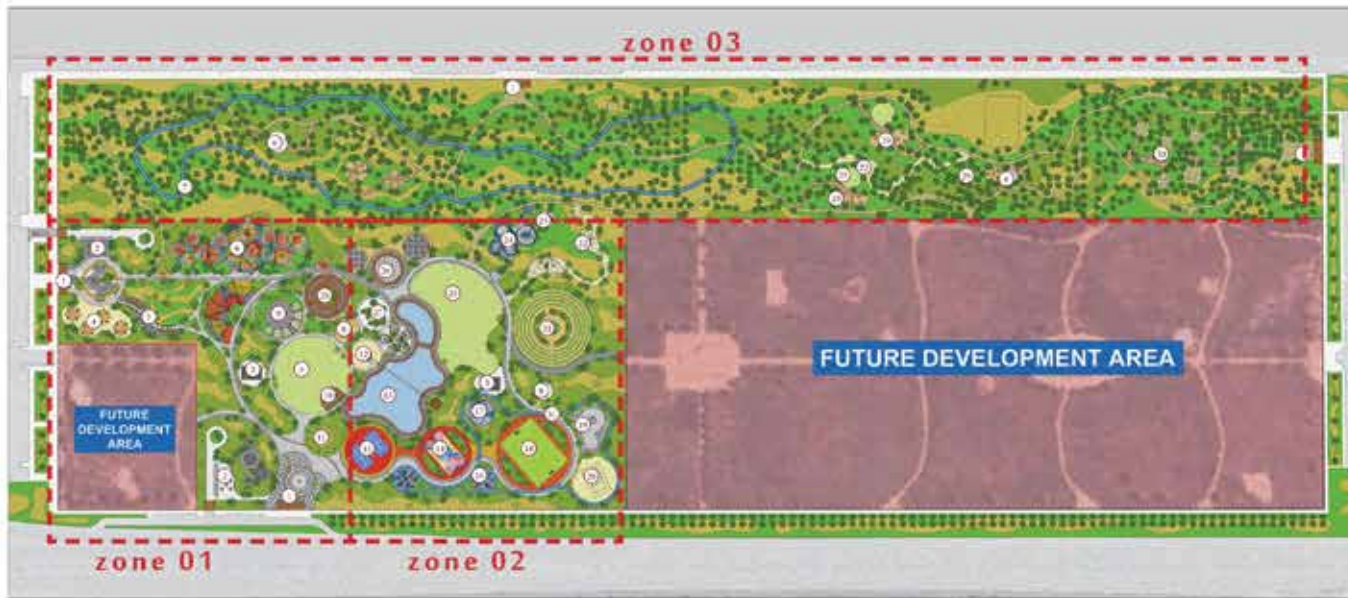

Concept Design



Camping Area



Trampo Seating Area



Hardscape Palette



Lighting



Softscape Palette



Signage Wayfinding



Softscape Palette



Signage Wayfinding

Concept Design

The concept design of Baniyas Droplet Park is rooted in the organic geometry of water droplets, creating a layout that flows seamlessly across distinct zones. The plan balances active and passive areas, integrating play zones, sports courts, and community spaces with quiet natural retreats. Each droplet-inspired form shapes pathways, lakes, seating zones, and activity clusters, ensuring a cohesive park identity that celebrates both movement and connectivity. Future development areas are thoughtfully planned to expand the park's offerings while maintaining its unified vision.

The camping area introduces an immersive outdoor experience, inviting families and groups to connect with nature in a safe and sustainable setting. Surrounded by native planting and shaded walkways, this zone provides a sense of escape within the city, encouraging leisure, adventure, and community bonding under the open sky.

The Trampo Seating Area blends fun and functionality by combining recreational play with comfortable gathering spots. Supporting the park's identity, key design elements — Hardscape Palette, Lighting, Softscape Palette, and Signage & Wayfinding — have been carefully selected to enhance user experience. Organic paving and curved seating define the hardscape, while energy-efficient lighting adds ambience and safety.

A Destination of Play, Wellness & Togetherness

Play Zone

The Play Zone is envisioned as a world of wonder, where children immerse themselves in creativity and discovery. Sculpted play structures, adventure trails, and water-inspired features invite exploration, transforming playtime into an experience that stimulates both imagination and movement in a safe, vibrant setting..

Activity Zone

Balancing leisure with vitality, the Activity Zone has been crafted as a landscape of energy and motion. From multi-purpose sports courts and a dynamic skate park to shaded running and walking tracks, every element encourages wellness while weaving seamlessly into the natural fabric of the park. Designed for children and families, it promotes active engagement

Socializing, Gathering

At the heart of the park lies the Social Zone — a collection of intimate yet engaging spaces designed to nurture connection. The café, camping grounds, and thoughtfully curated maze become settings for moments of togetherness, offering opportunities for reflection, gathering, and shared experiences.



Adventure Play



Climbing wall



Splash Pad



Sports Court



Sports Court



Running & Walking Track



Cafe



Camping



Maze



Abu Samra Park

Abu Dhabi

An Oasis of Harmony

Abu Samra Park is conceived as a contemporary green sanctuary, transforming a raw parcel of land into a vibrant and sustainable public realm. Sensitive to the desert climate, the design integrates native planting, shaded walkways, and open circulation, creating a landscape that invites both residents and visitors to engage with nature in comfort throughout the year. Every aspect of Abu Samra Park — from lighting and furniture to planting and irrigation — has been executed with precision and care.

At its core, the park offers a harmonious balance between activity and repose. A central water feature introduces a cooling and welcoming presence, while carefully placed seating, shaded structures, and gracefully designed pathways encourage walking, gathering, and relaxation. These elements combine to establish an atmosphere that is both socially engaging and environmentally responsive. The park reflects a strong commitment to environmental stewardship. Native plantings minimize water use, while smart irrigation and energy-efficient lighting reduce environmental impact. Every element has been thoughtfully designed to ensure sustainability without compromising comfort or aesthetics.



It stands as a landmark destination where nature and urban life converge seamlessly. Its design goes beyond greenery, creating a place that is both functional and uplifting, where the landscape and built elements work together to provide comfort and vitality for all who visit.

The park is equipped with a wide array of amenities that cater to different ages and lifestyles. Families can enjoy safe and engaging play areas for children, while fitness enthusiasts have access to sports courts, shaded jogging paths, and open spaces designed for active recreation. These facilities are thoughtfully distributed, ensuring accessibility and encouraging community-wide participation. In every detail, the park reflects a commitment to sustainability and environmental responsibility. Native plant species reduce water consumption, while advanced irrigation systems ensure resources

are used efficiently. The careful integration of lighting and landscaping minimizes energy use while maintaining safety and ambience.

More than just a green space, Abu Samra Park serves as a hub for social interaction, wellbeing, and cultural connection. Its blend of natural beauty and modern amenities fosters a sense of belonging, making it not only a place to visit but a destination to return to, time and again. The coffee shop and seating areas are designed to foster community interaction, offering a welcoming spot for relaxation and casual gatherings. It is surrounded by greenery and shaded spaces,



Royal Garden Park

Falaj Hazza , UAE

Your Everyday Retreat

Royal Garden Park is envisioned as a contemporary green sanctuary, blending nature and artistry into one inspiring destination. The park is thoughtfully designed to create harmony between landscaped spaces, vibrant play zones, and cultural gathering areas, making it a serene yet engaging retreat for all ages. It is a destination that invites joy, encourages wellness, and inspires togetherness every single day.

At its heart, the park offers a balance between recreation and relaxation. Visitors can enjoy shaded sitting areas, creative play structures, and open plazas designed for both activity and contemplation. Every corner is shaped to encourage community interaction, wellness, and a stronger connection with nature. Royal Garden Park is more than just an urban escape—it is a celebration of outdoor living. With its blend of greenery, art-inspired installations, and thoughtfully planned amenities, it provides a timeless retreat in the heart of the city, inviting families, friends, and individuals to experience moments of joy and harmony.



Beyond its recreational appeal, Royal Garden Park is envisioned as a cultural hub. Open plazas and flexible spaces provide opportunities for social gatherings, community events, and cultural celebrations, turning the park into a lively stage for collective experiences.

The layout integrates sustainability at every level, with eco-friendly materials, native plantings, and innovative structures that reduce environmental impact. These elements highlight the park's role as a forward-thinking, future-ready landmark. Wellness is at the core of the park's vision. Jogging tracks, fitness zones, and outdoor exercise spaces are seamlessly woven into the green setting, encouraging healthy living and an active lifestyle for all generations.

Royal Garden Park is more than a green space—it is a symbol of harmony between people and nature. With its timeless design and thoughtful features, it creates a welcoming haven in the heart of the city, inspiring relaxation, connection, and a sense of belonging.

This thoughtful approach ensures that the park becomes a shared destination where every visitor can find comfort, activity, and enjoyment. It is a place where nature, culture, and community seamlessly come together.



Bida Saif

United Arab Emirates

Sustainable Spaces, Lasting Harmony.

Bida Saif is envisioned as a vibrant public landscape that blends contemporary design with natural beauty. Thoughtfully planned to suit the desert climate, the project features shaded walkways, native planting, and well-integrated circulation routes, creating a functional yet welcoming environment for all. The design embraces both activity and relaxation. From serene garden spaces and shaded seating areas to open plazas and gather

ing spots, every element has been crafted to encourage social interaction, wellness, and community engagement. With sustainability at its core, the project incorporates efficient irrigation systems, eco-conscious materials, and greenery that thrives naturally in the regional climate. This approach ensures a balance between environmental sensitivity and modern convenience.

Bida Saif is more than a landscaped development—it is a destination that redefines outdoor living. By offering a harmonious blend of design, sustainability, and natural serenity, it creates a timeless space for relaxation, connection, and community life.



Villa Landscaping - VIP

United Arab Emirates

Nature Refined, Living Redefined.

This Villa Landscaping project reimagines outdoor spaces into a refined sanctuary of comfort and elegance. Centered around a distinctive waterfront feature, the design creates a seamless blend of modern architecture and natural tranquility, offering residents a place to relax, gather, and connect. Every element has been thoughtfully planned to suit both leisure and community living. From shaded seating lounges and scenic garden paths to in-

viting social areas, the layout fosters wellness, interaction, and a sense of belonging within the villa environment. The project highlights sustainability through the use of native planting, efficient irrigation systems, and eco-conscious materials, ensuring long-term resilience while maintaining aesthetic beauty.

Villa Landscaping – VIP is more than landscaping; it is a statement of lifestyle. By combining water, greenery, and contemporary design, it sets a new standard for luxurious outdoor living in the heart of the city.



Villa Landscaping - VIP

United Arab Emirates

Sustainable Beauty, Redefined.

Located in Al Ain, Abu Dhabi, this project reimagines a raw land parcel into a functional and sustainable villa landscape. Designed with the desert climate in mind, it features native planting, shaded walkways, and balanced circulation that together create a refined outdoor retreat. Every design detail has been carefully crafted to blend modern architecture with natural harmony. From seating and gathering zones to shaded gardens, the layout encourages both relaxation and social interaction, while maintaining environmental sensitivity.

The project's landscaping approach integrates precision planning and thoughtful irrigation systems, ensuring that the greenery thrives year-round. By incorporating sustainable materials and water-conscious planting, the design enhances resilience while preserving natural beauty.

Villa Landscaping – VIP is more than just a transformation of space; it is a sanctuary that embodies comfort, elegance, and sustainability. It sets a new benchmark for villa landscaping by offering a serene escape that unites modern living with timeless natural charm.



Liva Tower by Emaar

United Arab Emirates

A modern landmark of sustainable urban living

18 Liva Tower by Emaar represents a forward-thinking vision of contemporary landscaping, transforming an urban setting into a functional, sustainable, and people-focused environment. The landscape design emphasizes both wellness and community engagement. Open green zones, interactive activity spaces, and tranquil garden retreats provide residents with opportunities to relax, exercise, and connect, creating a vibrant balance between urban life and natural calm. Every detail, from the choice of plants to the

integration of efficient irrigation systems, was carefully curated with environmental sensitivity. The result is a landscape that thrives sustainably, while adding aesthetic elegance to the tower's surroundings.

18 Liva Tower by Emaar is more than a residential project—it is a lifestyle destination. By blending modern design with natural serenity, it delivers a timeless urban oasis that enhances everyday living in the heart of the city. Designed to complement the desert climate, the project integrates native planting, shaded seating areas, and thoughtfully designed circulation routes that enhance comfort and accessibility.